

ITEM NO.	PART NO.	DESCRIPTION	QTY.
1	100-00089	BACKING PLATE	2
2	100-00492	SPRING HANGER	2
3	100-01503	FENDER BRACKET	2
4	221-00014	ANGLE	1

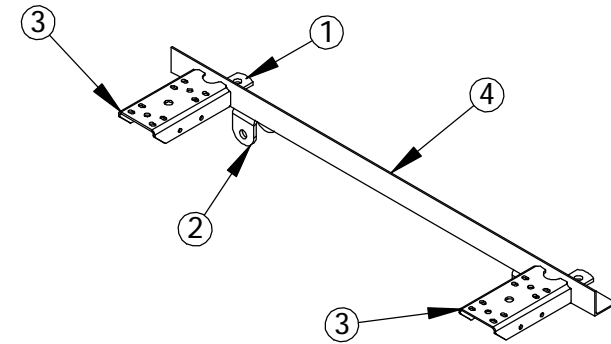

DETAIL A

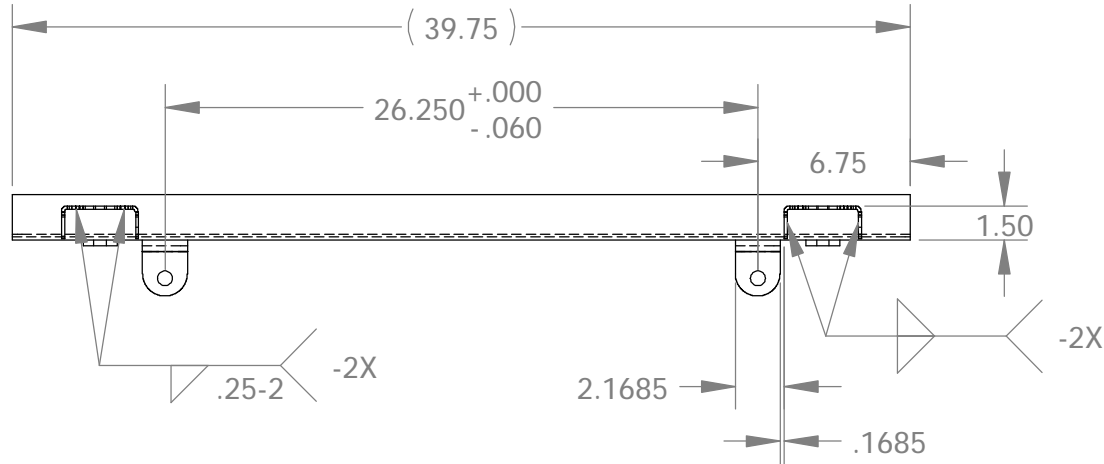
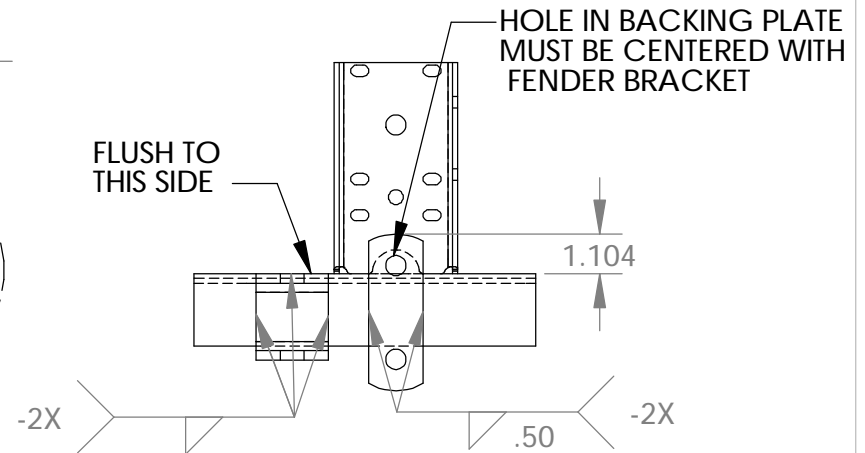
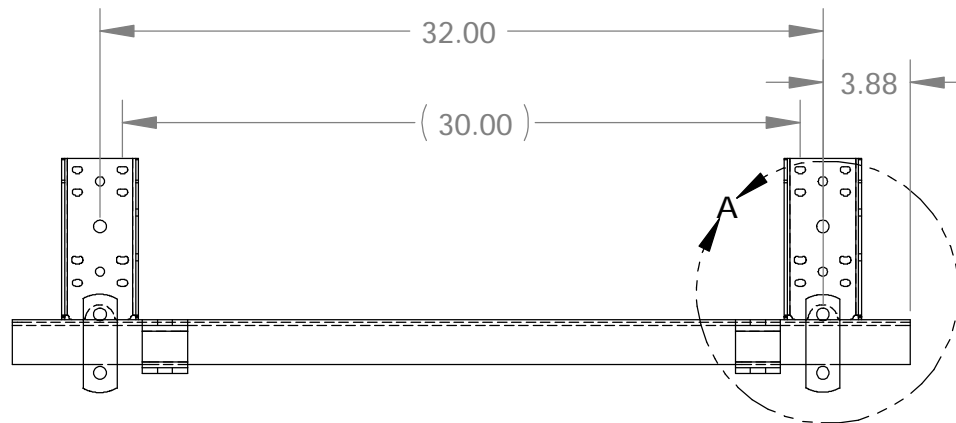

NOTES:

- 1.) ALL PAINTED & ZINC PARTS MUST BE PACKAGED PER INSTRUCTIONS:
 100-00999 N/A
 100-00999(80)M USES 375-00125 INSTRUCTIONS

ALL DIMENSIONS ARE IN INCHES UNLESS OTHERWISE STATED TOLERANCES EXCEPT AS NOTED DECIMALS:

.X	±0.100
.XX	±0.060
.XXX	±0.030
.XXXX	±0.010

ANGLES:
 ±1°
 ALL FORMED ANGLES EQUAL 90° UNLESS NOTED OTHERWISE

() INDICATES REFERENCE

THE INFORMATION IN THIS DRAWING IS THE SOLE PROPERTY OF KARAVAN TRAILERS, INC. ANY REPRODUCTION IN PART OR WHOLE WITHOUT THE WRITTEN PERMISSION OF KARAVAN TRAILERS, INC. IS PROHIBITED.

APPROVED BY:

DRAWN BY:

DATE:

10-27-97

SHEET:

1 OF 1

SCALE:

N/A

KARAVAN
TRAILERS

TITLE:

13" FENDER WELDMENT
(FOR 14" TIRE)

MAT'L:

SEE B.O.M.

FINISH:

-ZN

DWG. #:

300-00999-H

DWG. REV.	ECR/NDR NUMBER	REVISED BY	DATE	DESCRIPTION
H/2	14592	MH	05-12-08	UPDATED WELD SYMBOLS
H/1	13922	CPS	02-15-07	ADDED NOTE 1.)

First Piece - In Process Inspection Sheet

Vendor _____

Description: **13" Fender Weldment**

Part # **300-00999**

Rev. **H/2**

QA Approval: K. Baumhardt

JOB# _____

Characteristic	Tol.	Method	Freq.	1st Piece	A/R	2	A/R	3	A/R	4	A/R	5	A/R	6	A/R	Last piece	A/R	Inspected By:	
WELD																		1	/
26.250	+ .000 - .060	Tape	2x per shift															3	/
6.75	± .060	Tape	2x per shift															4	/
1.50	± .060	Tape	2x per shift															4	/
2.1685	± .010	Tape	2x per shift															5	/
.1685	± .010	Tape	2x per shift															6	/
32.00	± .060	Tape	2x per shift															7	/
3.88	N/A	Protractor	2x per shift																
DETAIL A																			
1.104	± .060	Tape	2x per shift																
Flush to this side	NA	Visual	Every piece																
Hole in backing plate must be centered with fender bracket	NA	Visual	Every piece																
Weld per print	NA	Visual	Every piece																
Remove all visible weld splatter, every piece	NA	Visual	Document 4x per shift																