

# attwood®

## Scupper Valve 3876, 3871

Attwood marine hardware, navigational lighting, bilge pumps, and other marine accessories are specified more than any other brand by America's best-known boat manufacturers as original equipment. Look to Attwood for quality replacement parts and marine accessories.

### SAVE THESE INSTRUCTIONS

Form Number 69247 Rev. B

03-10

### FEATURES:

The Attwood Scupper Valve is designed for boats with self-bailing cockpits. It is designed to be mounted over existing thru-hull fittings up to 2" (51mm). The Scupper Valve is a combination of a corrosion-resistant retainer ring, screws, rubber flapper valve and gasket. The rubber flapper valve opens outward to allow water to exit and automatically closes to help prevent backwash from entering the cockpit.

The Attwood Scupper Valve is to be mounted on the transom above the boat's maximum water line as determined by the boat's draft at the maximum loading as recommended by the boat manufacturer.

### TOOLS REQUIRED:

1. Drill and drill bit
2. Phillips screwdriver

### INSTALLATION INSTRUCTIONS:

NOTE: The Scupper Valve can be mounted two ways: on the transom above the water line (Figure 1), or the boat floor via thru-hull drain fitting, hose, and cockpit drain (Figure 2).

Figure 1

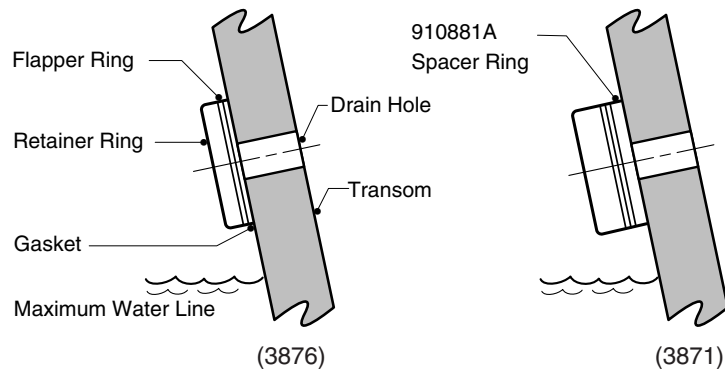
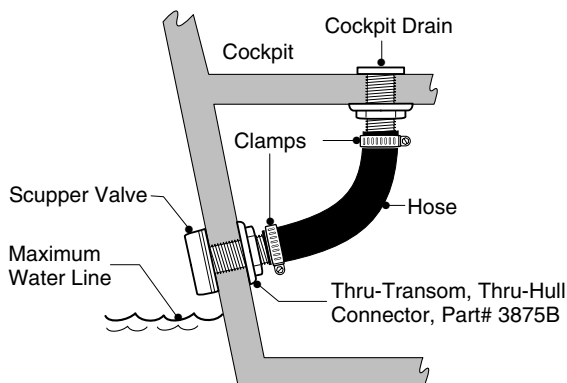
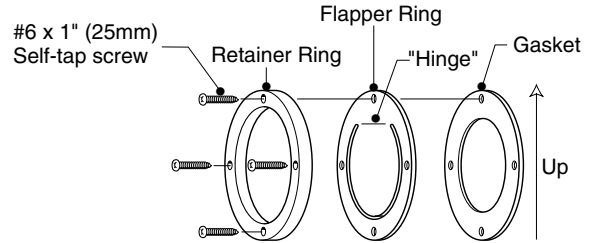

Figure 2



1. Use the flapper valve as a template and place over existing drain hole in the transom. Position it vertically with the "hinge" on top, while the flapper freely opens from the bottom (Figure 3).

Figure 3 (3876)



Note: when using the 3871 Scupper Valve for transom mounting, you **must** use a second retainer ring, #910881a, to back-up the flipper valve (figure 4). This part can be purchased separately.

Figure 4 (3871)

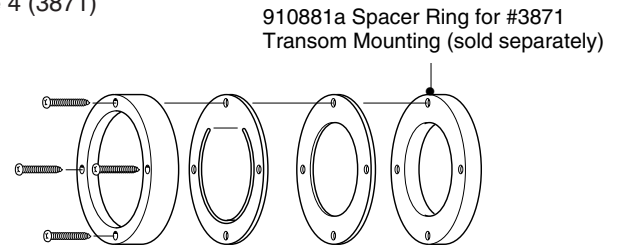

2. Mark holes and drill to accommodate #6 x 1" (25mm) self-tapping screws.
3. Mount the gasket over the drain hole, the flapper valve over the gasket, and then the retaining ring over the flapper valve while aligning the screw holes. Fasten and tighten screws.

### DO NOT OVER-TIGHTEN

### ⚠ WARNING:

The Attwood Scupper Valve is to be mounted only above the boat's maximum load water line as determined by the boat's draft as recommended by the boat manufacturer.

### ATTWOOD LIMITED WARRANTY

Attwood Corporation, 1016 North Monroe, Lowell, Michigan 49331 ("Attwood") warrants to the original consumer purchaser that Attwood brand products will be free from defects in materials and workmanship under normal use and service for one year from the date of original consumer purchases.

This limited warranty is not applicable if the product has been damaged by accident, improper installation, unreasonable or improper use, lack of proper maintenance, unauthorized repairs or modifications, normal wear and tear, or other causes not arising out of defects in materials or workmanship.

Attwood products are warranted for use on pleasure boats. Any other use—including but not limited to commercial, racing, or non-marine use—are not covered under this warranty. Attwood's obligation under this warranty is limited to repair of the product at Attwood's plant or replacement of the products at Attwood's option without expense to the original consumer purchaser. Any expenses involved in the removal, reinstallation or transportation of the product are not covered by this warranty. The product must be returned to Attwood's plant at the address above, postage pre-paid, and insured with proof of original purchase including date. If Attwood is unable to replace the product and repair is not commercially practical or cannot be timely made, or if the original consumer purchaser is willing to accept a refund in lieu of repair or replacement, Attwood may refund the purchase price, less an amount for depreciation. The acceptance by Attwood of any product returned or any refund provided by Attwood shall not be deemed an admission that the product is defective or in violation of any warranty. Products that are replaced or for which a refund is issued become the property of Attwood.

This warranty is Attwood's only expressed warranty of these products. No implied warranty including, without limitation, the implied warranties of merchantability and fitness for a particular purpose, shall be extended beyond the warranty period stated above for each product. Attwood shall not be liable for any damages, for loss of use of this product, nor for any other incidental or consequential damages, costs, or expenses.

Some states do not allow limitations on how long an implied warranty lasts or the exclusion or limitation of incidental or consequential damages, so the above limitations and exclusions may not apply to you. This warranty gives you specific legal rights, and you may have other rights which vary from state to state.