

FLEXIRIDE® HALF AXLE SYSTEM SUSPENSION MOUNTING DATA

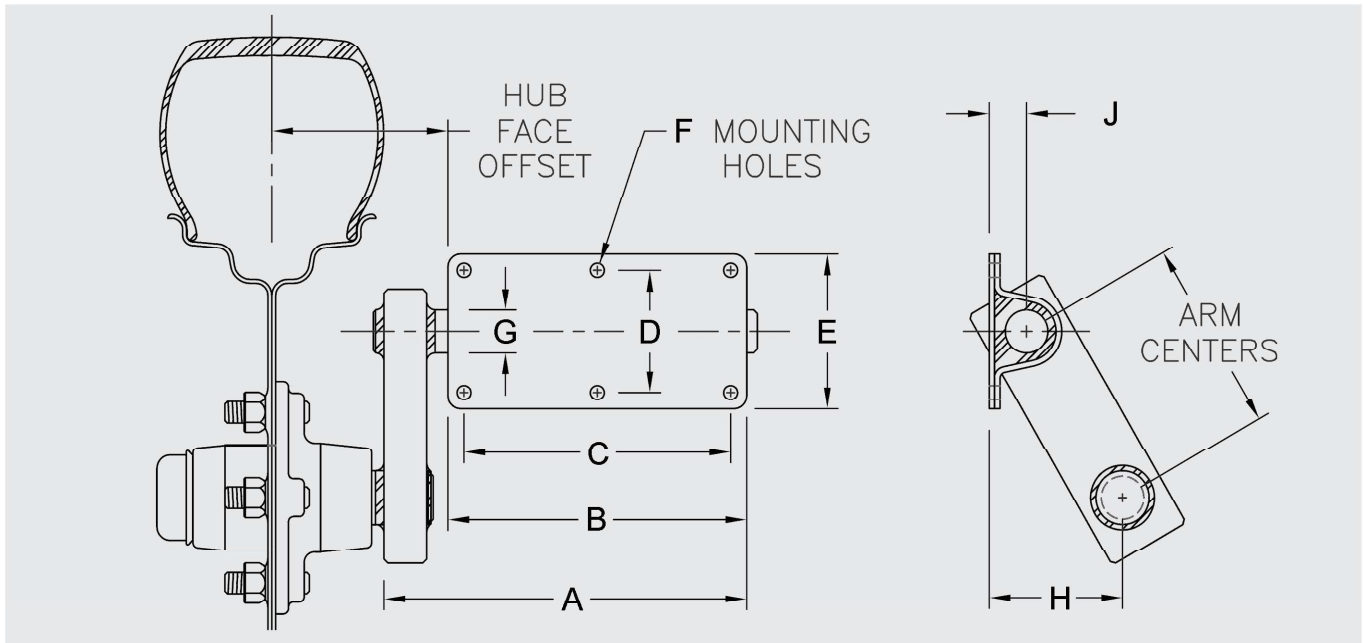

Part No.	FR-425-S	FR-550-S	FR-935-S	FR-1400	FR-2000	FR-3500
Style	British	British	British	Cartridge	Cartridge	Cartridge
Capacity/Pair	425 lbs.	550 lbs.	935 lbs.	1400 lbs.	2000 lbs.	3500 lbs.
Hub Face Offset	4.13	4.13	4.13	5.91	5.91	6.44
A	7.00	8.75	8.75	11.19	13.00	16.44
B	5.50	7.00	7.00	9.13	9.13	13.63
C	4.75	6.250	6.250	7.625	7.625	11.625
D	2.38	2.875	2.875	3.375	3.375	4.500
E	3.125	3.63	3.63	4.41	4.41	5.63
F (See Note 1)	6 for 5-16/24	6 for 5-16/24	6 for 5/16-24	6 for 3/8-24	6 for 3/8-24	8 for 1/2-20
G	0.875	1.00	1.00	1.50	1.50	1.75
H (See Note 2)	2.625*	3.125*	2.625*	3.50*	3.50*	3.91*
J	0.80	0.875	0.875	1.81	1.81	2.22
Arm Centers	3.50	4.50	3.50	4.50	4.50	4.50
Outer Bearing	L-44643	L-44643	L-44643	L-44649	L-44649	L-44649
Inner Bearing	L-44643	L-44643	L-44643	L-44649	L-44649	L-68149

Note 1 - All bolts and nuts grade 5 minimum

Note 2 - Nominal height calculated at zero load

* - Adjustable arm: starting angle must be within +10° and -45° from the horizontal.



For more information call or write:

The Universal Group Corp.™

1025 Thomas Busch Mem. Highway, Pennsauken, NJ 08110

Tel: (856) 488-1800 • Tel: (800) 777-1823 • Fax: (856) 488-9636 • Fax: (800) 360-9636

E-mail: info@theuniversalgroup.com • Website: www.theuniversalgroup.com

South Cooper Business Park, 1120 Eden Road, Suite 100, Arlington, TX 76001

Tel: (800) 637-4422 • Tel: (817) 417-6812 • Fax: (800) 360-9636

