

FLEET ENGINEERS

1800 EAST KEATING AVENUE
MUSKEGON, MI 49442
PH: 1-800-333-7890 • F: 231-777-2720

Installation Sheet #INS-97003

Tire Carrier Assembly Installation Instructions

WARNING:

Loss of tire in transit can cause bodily injury or property damage. Carry only one spare tire at a time. Do not carry the tire loose in the carrier. Tightly wrap the chain around the tire to eliminate slack and always fasten the snap-hook to the chain. Check regularly for bent members and fatigue in welds and rivets. Closely examine chain, snap-hook, and fasteners for wear, corrosion or fatigue. Replace or repair damaged or worn parts promptly.

ASSEMBLY INSTRUCTIONS

1. Attach "L" Frame Hanger (#2) to "U" Frame Hanger (#1) using the five (5) bolts (#3) and five (5) flange nuts (#4) provided.
2. Attach Snap-Hook (#5) to Link-Chain (#7) using Lap-Link (#6).
3. Slide the sixth link of the non-hook end of chain through the slot in the "L" Frame Hanger (#2). Place bolt (#8) through link and secure with locknut (#10) using washers (#9)

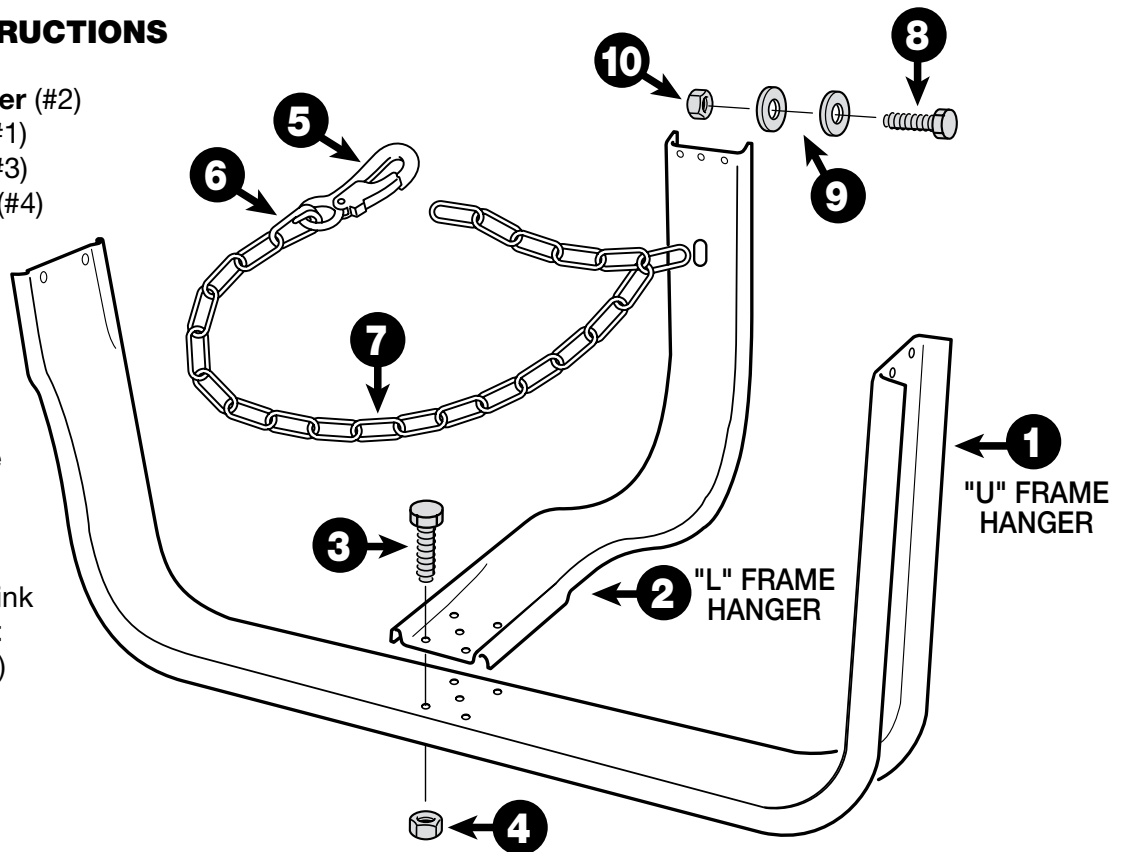

ITEM	DESCRIPTION	QTY
1	"U" Frame Hanger	1
2	"L" Frame Hanger	1
3	Bolt-Hex HD. 3/8-16 x 3/4	5
4	Nut - Flanged 3/8-16	5
5	Snap - Hook	1
6	Lap - Link	1
7	Link Chain - 52" Long	1
8	Bolt - Hex HD. 5/16-18 x 1	1
9	Washer - 3/4 OD x 5/16 ID x 1/16 Thick	2
10	Locknut - Hex HD. 5/16-18	1