

ITEM NO.	PART NUMBER	DESCRIPTION	QTY.
1	202-00002	BEARING CONE	4
2	210-00062	1.00"-14 SLOTTED JAM NUT	2
3	213-00006	5-BOLT HUB	2
4	217-00002	SEAL	2
5	229-00111	GREASE FITTING	2
6	229-00114	SAFETY PIN	2
7	229-00115	DUST CAP	2
8	229-00233	DUST CAP	2
9	300-01132	AXLE WELDMENT	1

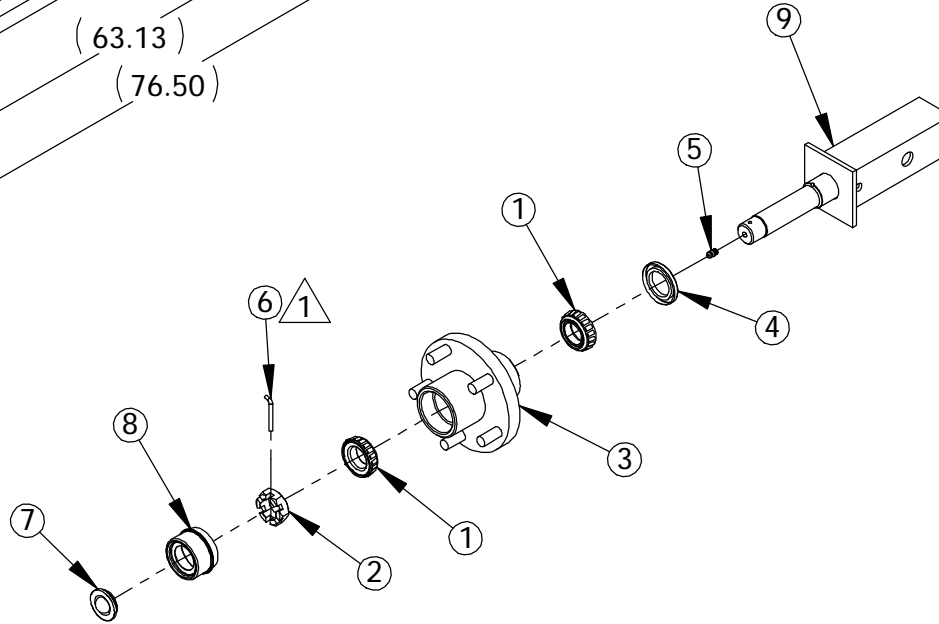
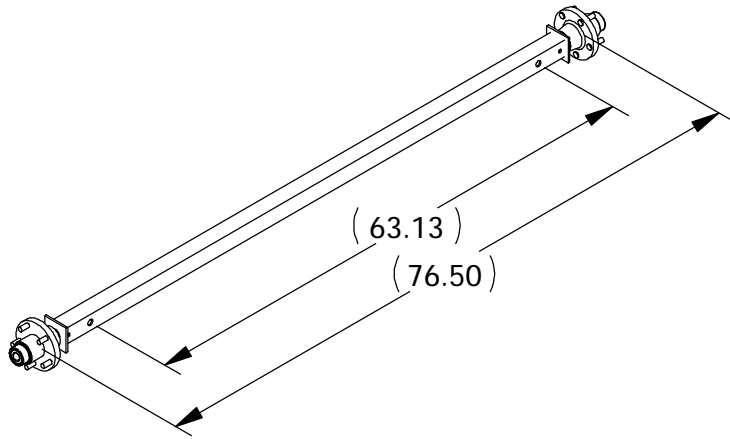

NOTE:

① 229-00114 IS TO BE USED WHEN PIN HOLE IS CENTERED ON SPINDLE.

② 207-00039 IS TO BE USED WHEN PIN HOLE IS OFFSET ON SPINDLE.

ALL DIMENSIONS ARE IN INCHES
UNLESS OTHERWISE STATED
TOLERANCES EXCEPT AS NOTED
DECIMALS:

.X ±0.100
.XX ±0.060
.XXX ±0.030
.XXXX ±0.010

ANGLES:
±1°

ALL FORMED ANGLES
EQUAL 90° UNLESS
NOTED OTHERWISE

() INDICATES REFERENCE

THE INFORMATION IN THIS DRAWING IS THE SOLE
PROPERTY OF KARAVAN TRAILERS, INC. ANY
REPRODUCTION IN PART OR WHOLE WITHOUT
THE WRITTEN PERMISSION OF KARAVAN TRAILERS,
INC. IS PROHIBITED.

APPROVED BY:
DOUG DRAY

DRAWN BY:
Amy L. Thomas

DATE:
08-22-00

SHEET:
1 OF 1

SCALE:
N/A

KARAVAN

TITLE:
AXLE ASSEMBLY

MAT'L:
SEE B.O.M.

FINISH:
N/A

DWG. #: **310-01252-E**

E/1	15833	MCS	02-20-15	ADDED NOTE
E	14232	MH	08-20-07	UPDATED 300-01132
DWG. REV.	ECR/NDR NUMBER	REVISED BY	DATE	DESCRIPTION

First Piece - In Process Inspection Sheet

Description: **Axle Assy.**

Run quantity _____

Part # 310-01252 Rev. E/1

QA Approval: K. Boomsma

P.O. / W.O. # _____

Characteristic	Tol.	Method	Freq.	1st piece	A/R	2nd	A/R	3rd	A/R	4th	A/R	5th	A/R	6th	A/R	Last piece	A/R	Inspected By/Date:
HUB																		1 /
Hub Adjusted Properly	Y/N	Visual	First/last piece															2 /
Cotter Pin in Castle Nut	Y/N	Visual	First/last piece															3 /
Dust Cap Installed Flush	Y/N	Visual	First/last piece															4 /
Grease Gun Set at 60 psi	Y/N	Visual	First/last piece															5 /
Grease Visible in Front Bearing	Y/N	Visual	First/last piece															6 /
																		7 /