

ALL DIMENSIONS ARE IN INCHES
UNLESS OTHERWISE STATED
TOLERANCES EXCEPT AS NOTED
DECIMALS:
.X ±0.100
.XX ±0.060
.XXX ±0.030
.XXXX ±0.010
ANGLES:
±1°
ALL FORMED ANGLES
EQUAL 90° UNLESS
NOTED OTHERWISE

() INDICATES REFERENCE

THE INFORMATION IN THIS DRAWING IS THE SOLE
PROPERTY OF KARAVAN TRAILERS, INC. ANY
REPRODUCTION IN PART OR WHOLE WITHOUT
THE WRITTEN PERMISSION OF KARAVAN TRAILERS,
INC. IS PROHIBITED.

APPROVED BY:

DRAWN BY:
Mike Stansbery
DATE:
03-31-2015
SHEET:
1 OF 2
SCALE:
N/A

KARAVAN

TITLE:
AXLE ASSEMBLY
MAT'L:
SEE B.O.M.
FINISH:
-ZN
DWG. #:
310-03631-A

DWG. REV.	ECR/NDR NUMBER	REVISED BY	DATE	DESCRIPTION
A	15792	MCS	03-31-15	DRAWING CREATED

ITEM NO.	PART NUMBER	DESCRIPTION	QTY.
1	202-00002	BEARING CONE	4
2	210-00062	1.00"-14 SLOTTED JAM NUT	2
3	213-00006	5-BOLT HUB	2
4	217-00002	SEAL	2
5	229-00111	GREASE FITTING	2
6	229-00114	SAFETY PIN	2
7	229-00115	DUST CAP	2
8	229-00233	DUST CAP	2
9	300-03294	AXLE WELDMENT	1

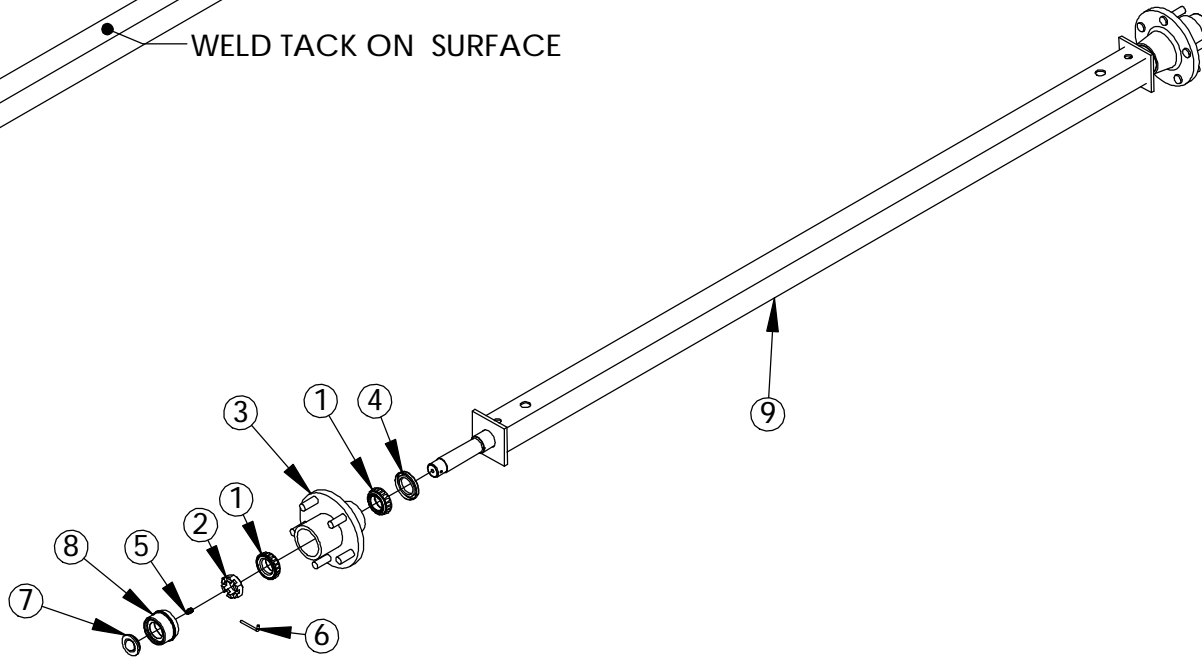
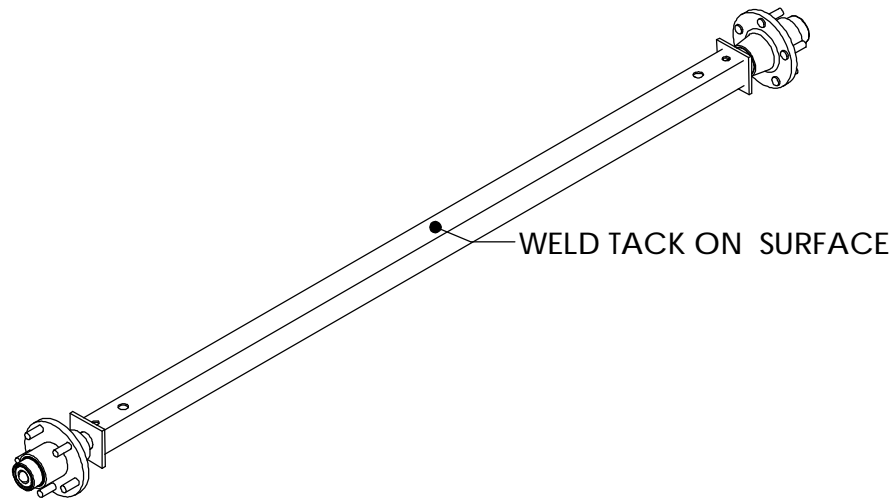

ALL DIMENSIONS ARE IN INCHES
UNLESS OTHERWISE STATED
TOLERANCES EXCEPT AS NOTED
DECIMALS:
.X ±0.100
.XX ±0.060
.XXX ±0.030
.XXXX ±0.010
ANGLES:
±1°
ALL FORMED ANGLES
EQUAL 90° UNLESS
NOTED OTHERWISE

() INDICATES REFERENCE

THE INFORMATION IN THIS DRAWING IS THE SOLE
PROPERTY OF KARAVAN TRAILERS, INC. ANY
REPRODUCTION IN PART OR WHOLE WITHOUT
THE WRITTEN PERMISSION OF KARAVAN TRAILERS,
INC. IS PROHIBITED.

APPROVED BY:

DRAWN BY:
Mike Stansbery

DATE:
03-31-2015

SHEET:
2 OF 2

SCALE:
N/A

KARAVAN

TITLE:
AXLE ASSEMBLY

MAT'L:
SEE B.O.M.

FINISH:
-ZN

DWG. #: **310-03631-A**

DWG. REV.	ECR/NDR NUMBER	REVISED BY	DATE	DESCRIPTION
A	15792	MCS	03-31-15	DRAWING CREATED

First Piece - In Process Inspection Sheet

Description: **Axle Assy.**

Run quantity _____

Part # 310-03631

Rev. A

QA Approval: K. Hopf

P.O. / W.O. # _____

Characteristic	Tol.	Method	Freq.	1st piece	A/R	2nd	A/R	3rd	A/R	4th	A/R	5th	A/R	6th	A/R	Last piece	A/R	Inspected By/Date:
DIMENSIONS																		1 /
54.00	±.094	Tape	First/last piece															2 /
HUB																		3 /
Hub Adjusted Properly	Y/N	Visual	First/last piece															4 /
Cotter Pin in Castle Nut	Y/N	Visual	First/last piece															5 /
Dust Cap Installed Flush	Y/N	Visual	First/last piece															6 /
Grease Gun Set at 60 psi	Y/N	Visual	First/last piece															7 /
Grease Visible in Front Bearing	Y/N	Visual	First/last piece															