

NOTE:  
1.) ALL SPINDLES MUST BE SURE LUBE TYPE (WITH GREASE ZERK INSTALLED).

ALL DIMENSIONS ARE IN INCHES  
UNLESS OTHERWISE STATED  
TOLERANCES EXCEPT AS NOTED  
DECIMALS:

.X ±0.100  
.XX ±0.060  
.XXX ±0.030  
.XXXX ±0.010

ANGLES:

±1°

ALL FORMED ANGLES  
EQUAL 90° UNLESS  
NOTED OTHERWISE

( ) INDICATES REFERENCE

THE INFORMATION IN THIS DRAWING IS THE SOLE  
PROPERTY OF KARAVAN TRAILERS, INC. ANY  
REPRODUCTION IN PART OR WHOLE WITHOUT  
THE WRITTEN PERMISSION OF KARAVAN TRAILERS,  
INC. IS PROHIBITED.

APPROVED BY:

~ ~ ~

DRAWN BY:

JOEL NEHRING

DATE:

03-17-09

SHEET:

1 OF 2

SCALE:

N/A

**KARAVAN**  
TRAILERS

TITLE:

TORSION AXLE 1800#  
W/ HUBS-56

MAT'L:

PURCHASED

FINISH:

-BL, -GL

DWG. #:

200-00073-B

DWG. REV.	ECR/NDR NUMBER	REVISED BY	DATE	DESCRIPTION
B	14837	JRN	04-22-09	56.520 WAS 56.583, 2.297 WAS 2.391, $\phi .4375 \times .6563$ WAS $\phi .5625 \times .7188$ , $\phi .4375 \times 1.1875$ WAS $\phi .5625 \times 1.3125$
A	14837	JRN	02-10-09	DRAWING CREATED

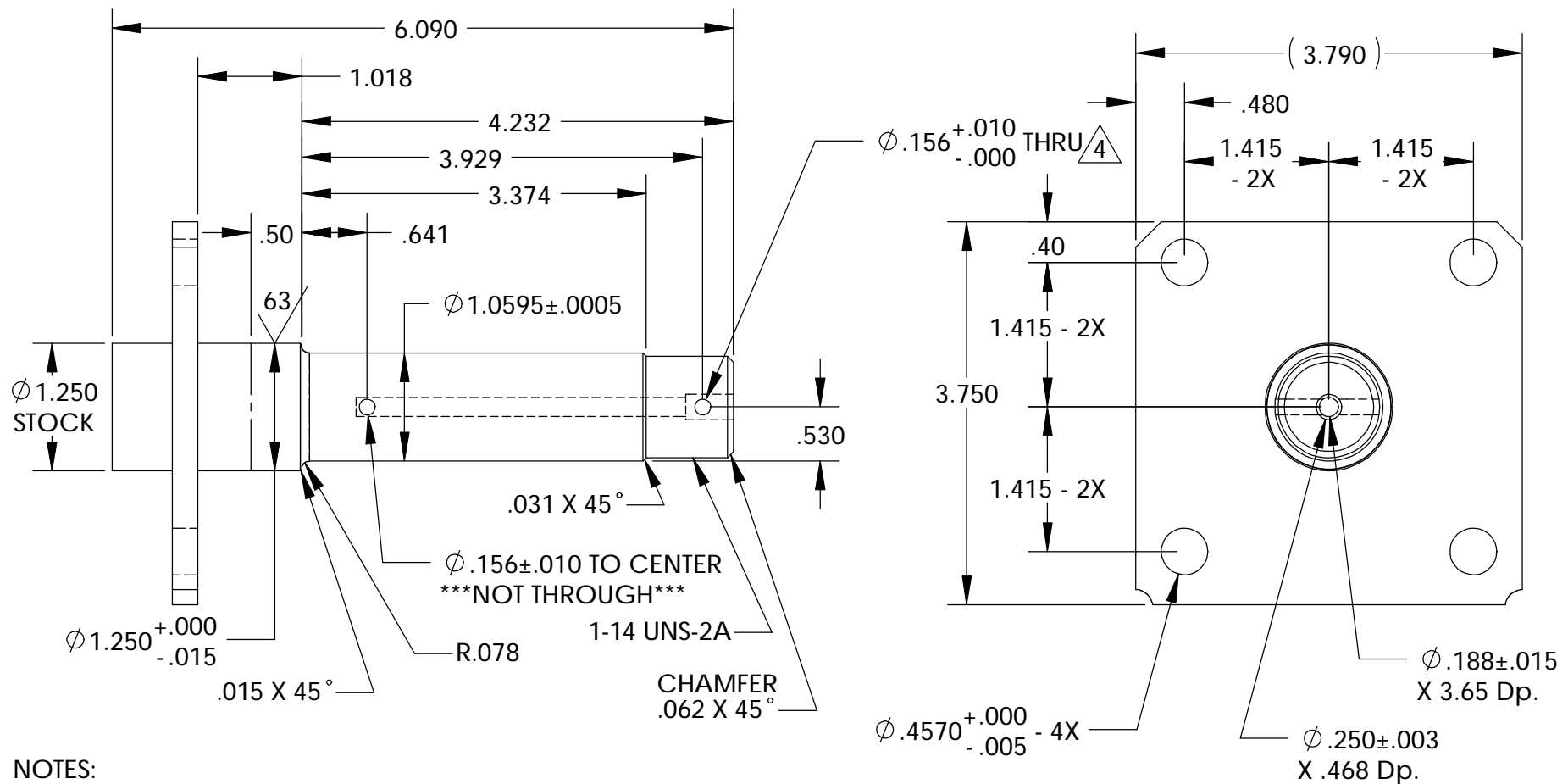

**NOTES:**

- 1.) PART MUST BE BURR FREE
- 2.) HOLES MUST BE FREE OF ANY/ALL CHIPS
- 3.) HOLE ORIENTATION, ONE TO ANOTHER, NON-CRITICAL
- 4.) SIZE FOR "SNUG FIT" OF P/N 207-00019
- 5.) ALL MACH'D SURFACES TO BE 63
- 6.) CAPACITY 1350#

ALL DIMENSIONS ARE IN INCHES  
UNLESS OTHERWISE STATED  
TOLERANCES EXCEPT AS NOTED  
DECIMALS:

.X ±0.100  
.XX ±0.060  
.XXX ±0.030  
.XXXX ±0.010

ANGLES:  
±1°

ALL FORMED ANGLES  
EQUAL 90° UNLESS  
NOTED OTHERWISE

( ) INDICATES REFERENCE

THE INFORMATION IN THIS DRAWING IS THE SOLE  
PROPERTY OF KARAVAN TRAILERS, INC. ANY  
REPRODUCTION IN PART OR WHOLE WITHOUT  
THE WRITTEN PERMISSION OF KARAVAN TRAILERS,  
INC. IS PROHIBITED.

APPROVED BY:

---

DRAWN BY:

JOEL NEHRING

DATE:

03-17-09

SHEET:

2 OF 2

SCALE:

N/A

**KARAVAN**  
TRAILERS

TITLE:

TORSION AXLE 1800#  
W/ HUBS-56

MAT'L:

PURCHASED

FINISH:

-BL, -GL

DWG. #:

200-00073-B

DWG. REV.	ECR/NDR NUMBER	REVISED BY	DATE	DESCRIPTION
B	14837	JRN	04-22-09	56.520 WAS 56.583, 2.297 WAS 2.391, Ø.4375 X .6563 WAS Ø.5625 X .7188, Ø.4375 X 1.1875 WAS Ø.5625 X 1.3125
A	14837	JRN	03-17-09	DRAWING CREATED